

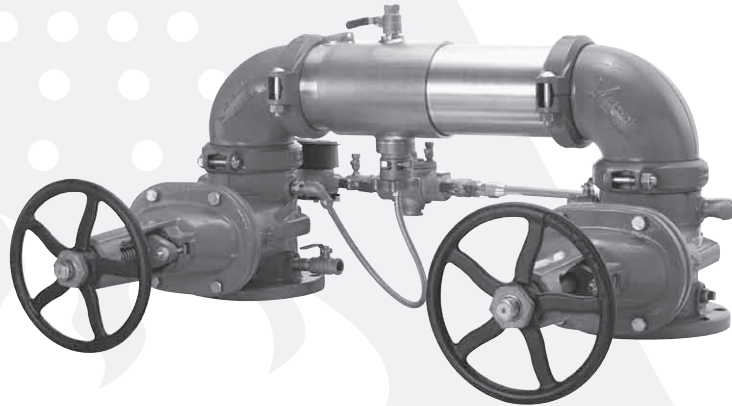

# Colt™ Series C500, C500N, C500Z

## Reduced Pressure Detector Assemblies

Sizes: 2½" – 10" (65 – 250mm)



C500N OSY

### Features

- Extremely Compact Design
- 70% Lighter than Traditional Designs
- 304 (Schedule 40) Stainless Steel Housing & Sleeve
- Groove Fittings Allow Integral Pipeline Adjustment
- Patented Link Check Provides Lowest Pressure Loss
- Unmatched Ease of Serviceability
- Replaceable Check Disc Rubber
- Available with Grooved Butterfly Valve Shutoffs
- Bottom Mounted Cast Stainless Steel Relief Valve
- Metered Bypass to Detect Leakage or Theft of Water from the Fire Sprinkler System

The Colt C500, C500N, C500Z Reduced Pressure Detector Assemblies provide protection to the potable water system from contamination in accordance with national plumbing codes. The Colt C500, C500N, C500Z are normally used in health-hazard applications to protect against backsiphonage, backpressure and the fouling of either check valve. The Colt C500, C500N, C500Z are used to monitor unauthorized use of water from the fire protection system.

### Specifications

The Colt C500, C500N, C500Z Reduced Pressure Detector Assemblies shall consist of two independent Link Check modules, a differential pressure relief valve located between and below the two modules, two drip tight shutoff valves, and required test cocks. Link Check modules and relief valve shall be contained within a sleeve accessible single housing constructed from 304 (Schedule 40) stainless steel pipe with groove end connections. Link Checks shall have reversible elastomer discs and in operation produce drip tight closure against the reverse flow of liquid caused by backpressure or backsiphonage. The bypass assembly consists of a meter registering either gallon or cubic measurements, a reduced pressure zone assembly and required test cocks. Assembly shall be Colt C500, C500N, C500Z as manufactured by the Ames Company.

---

Job Name \_\_\_\_\_ Contractor \_\_\_\_\_  
 Job Location \_\_\_\_\_ Approval \_\_\_\_\_  
 Engineer \_\_\_\_\_ Contractor's P.O. No. \_\_\_\_\_  
 Approval \_\_\_\_\_ Representative \_\_\_\_\_

*Ames product specifications in U.S. customary units and metric are approximate and are provided for reference only. For precise measurements, please contact Ames Technical Service. Ames reserves the right to change or modify product design, construction, specifications, or materials without prior notice and without incurring any obligation to make such changes and modifications on Ames products previously or subsequently sold.*

## Configurations

- Horizontal
- “Z” pattern horizontal
- “N” pattern horizontal

## Materials

- Housing & Sleeve: 304 (Schedule 40) Stainless Steel
- Elastomers: EPDM, Silicone and Buna ‘N’
- Link Checks: Noryl®, Stainless Steel
- Check Discs: Reversible Silicone or EPDM
- Test Cocks: Bronze Body Nickel Plated
- Pins & Fasteners: 300 Series Stainless Steel
- Springs: Stainless Steel

## Available Models

Suffix:

OSY - UL/FM outside stem and yoke resilient seated gate valves

BFG - UL/FM grooved gear operated butterfly valves w/tamper switch

\*OSY FxG - Flanged inlet gate connection and grooved outlet gate connection

\*OSY GxG - Grooved inlet gate connection and flanged outlet gate connection

\*OSY GxG - Grooved inlet gate connection and grooved outlet gate connection

Available with grooved NRS gate valves - consult factory\*

Post indicator plate and operating nut available - consult factory\*

\*Consult factory for dimensions

## Pressure — Temperature

Temperature Range: 33°F – 140°F (0.5°C – 60°C)

Maximum Working Pressure: 175psi (12.1 bar)

## Dimensions — Weights

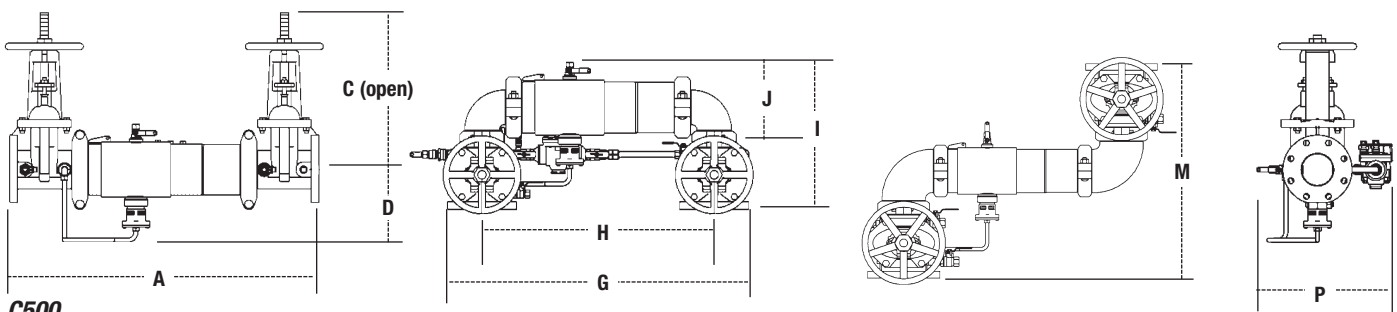

**C500**

SIZE (DN)		DIMENSIONS														WEIGHT							
in.	mm	A		C (OSY)		D		G		H		I		J		M		P		C500	C500N		
		in.	mm	in.	mm	in.	mm	in.	mm	in.	mm	in.	mm	in.	mm	in.	mm	in.	mm	lbs.	kgs.		
2½	65	31	787	16¾	416	6½	165	29⅞	738	22	559	15½	393	8⅜	223	21⅞	548	13⅜	335	142	64	150	68
3	80	31⅞	805	18⅞	479	6⅞	170	30¼	768	22¾	578	17½	435	9⅞	233	23⅞	587	14½	368	162	73	175	79
4	100	33⅞	856	22¾	578	7	178	33	838	24	610	18½	470	9⅞	252	26½	673	15⅞	386	178	81	201	91
6	150	43½	1105	30⅞	765	8½	216	44¾	1137	33¾	857	23⅞	589	13⅞	332	32¾	832	19	483	312	142	353	160
8	200	50	1270	37¾	959	9⅞	246	54⅞	1375	40⅞	1032	27⅞	697	15⅞	399	37⅞	943	21⅞	538	497	225	572	259
10	250	57½	1460	45¾	1162	11⅞	285	66	1676	50	1270	32½	826	17⅞	440	46⅞	1178	24	610	797	362	964	437

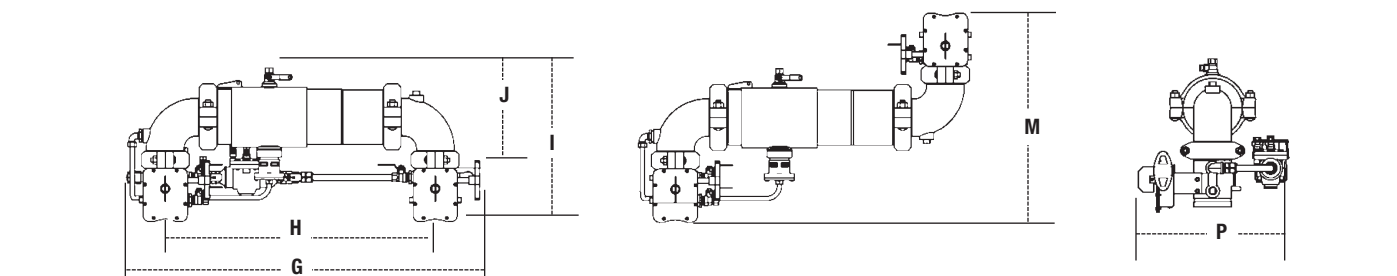

**C500BFG**

SIZE (DN)		DIMENSIONS										WEIGHT			
in.	mm	G		H		I		J		M		P		C500BFG	
		in.	mm	in.	mm	in.	mm	in.	mm	in.	mm	in.	mm	lbs.	kgs.
2½	65	32½	826	23½	597	15½	394	9½	241	21⅜	555	15⅜	402	81	37
3	80	34	864	24½	622	16⅞	414	10⅞	256	23⅞	587	16⅞	410	84	38
4	100	35⅞	905	26	660	17⅞	437	10⅞	279	24⅞	634	16⅞	422	101	46
6	150	46½	1181	35⅞	908	20½	521	13½	343	28¼	718	19	483	174	79

Noryl® is a registered trademark of SABIC Innovative Plastics™.

# Approvals



For additional approval information please contact the factory or visit our website at [www.amesfirewater.com](http://www.amesfirewater.com)

## Capacity

UL/FM Certified Flow Characteristics

N&Z Flow characteristics collected using butterfly shutoff valves.

See literature S-Colt-400, 500 for gate valve flow characteristics

\* = Rated Flow \*\* = UL Tested

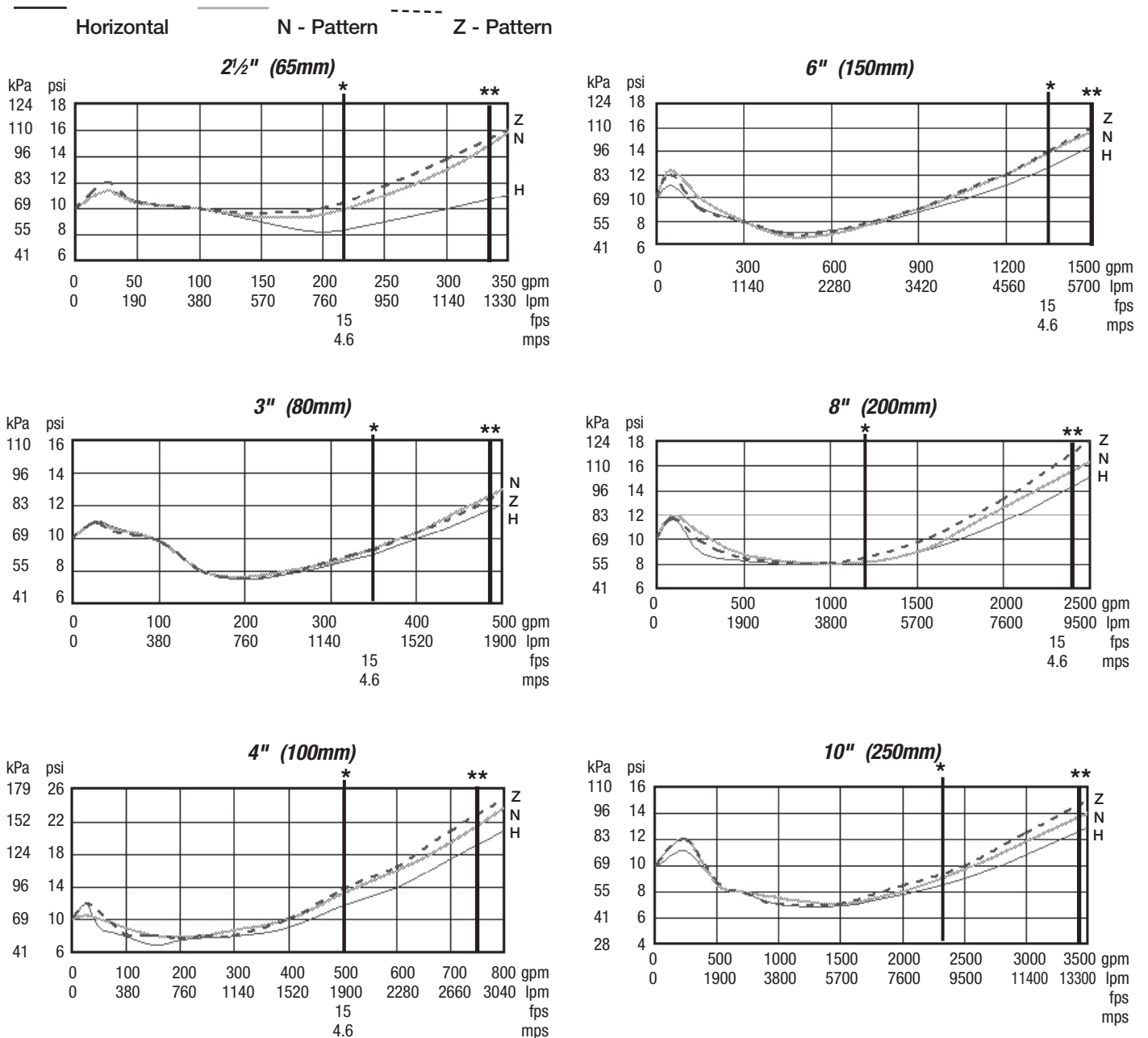

**IMPORTANT: INQUIRE WITH GOVERNING AUTHORITIES FOR LOCAL INSTALLATION REQUIREMENTS**

For additional information, visit our web site at: [www.amesfirewater.com](http://www.amesfirewater.com)



A Watts Water Technologies Company

[www.amesfirewater.com](http://www.amesfirewater.com)



**USA: Backflow-** 1427 N. Market Blvd • Suite #9 • Sacramento, CA 95834 • T: 916-928-0123 • F: 916-928-9333  
**Control Valves-** 18550 Hansen Road • Houston, TX 77075 • T: 713-943-0688 • F: 713-944-9445  
**Canada:** 5435 North Service Rd. • Burlington, ONT. L7L 5H7 • T: 905-332-4090 • F: 905-332-7068

ES-A-C500/C500N/C500Z 1006

© 2010 Ames Fire & Waterworks